

SPIROMETER



A BREATH
OF FRESH AIR

SPIROLYSER® Q13®



SCREENING FOR RESPIRATORY DISORDERS

- ▶ Easy, modern and quick
- ▶ Single-use Fleisch type sensor
- ▶ « **No Contact, No Risk** » Design:
 - no calibration
 - no disinfection
 - no cross-contamination

CE
0459





FOCUS ON TECHNOLOGY

For over 25 years FIM MEDICAL has chosen the Fleisch type pneumotachograph to design its spirometers for its reproduction and measurement accuracy qualities. A patented technology to reproduce sensor technique in a **disposable version**.

« NO CONTACT NO RISK » DESIGN

Each single-use **Qflow®** sensor is individually packaged in a pre-cut and printed sachet. **Thanks to an innovative ejection system, the used sensor is ejected after each test.** The operator's hands never come into direct contact with the sensor.

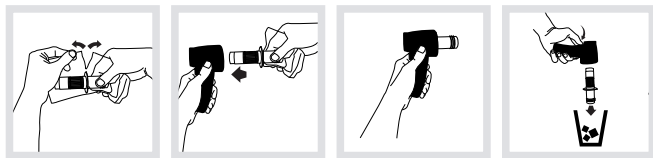

The **Spirolyser® Q13®** is one of the new generation of spirometers that **does not require calibration or disinfection**. Laboratory tests performed on the Qflow® demonstrate that cross-contamination between patients is **99,999%** risk-free.

The **Spirolyser® Q13®** is a computerised spirometer using single-use FLEISCH type sensors (patented technology), intended for use by health professionals. Its design, technology and ergonomics provide the essential tools for measuring respiratory capacity in preventive medicine.

SPIROLYSER® SPIROMETER Q13®

THE +

- ▶ Extensive tests available: Slow Vital Capacity (SVC), Forced Vital Capacity (FVC) pre- and post-medication, Maximum Voluntary Ventilation (MVV)
- ▶ Integrated weather station measures temperature, pressure and humidity
- ▶ Exports and print tests
- ▶ Comparison of tests over time
- ▶ Secure database
- ▶ Compatibility with many software packages
- ▶ Entertaining incentive videos
- ▶ Help interpreting results

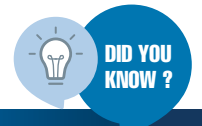

85% of patients consulted their doctor with respiratory symptoms indicative of chronic obstructive pulmonary disease (COPD) in the 5 years preceding their diagnosis.

HOW TO DIAGNOSE COPD?

By demonstrating the "obstructive ventilatory problem" through a spirometry.

YOUR DISTRIBUTOR



ACCESSORIES (included with device)

Travel Bag

OTHER ACCESSORIES (not included)

- Single-use Fleisch type Qflow sensors
- Nose clips (box of 200)
- Hans Rudolph 3L Series 5570 calibration syringe

2
YEARS
WARRANTY
Q13®



51 rue Antoine Primat - CS 60194
69625 Villeurbanne Cedex France

Tél +33 (0)4 72 34 89 89
Fax +33 (0)4 72 33 43 51
contact@fim-medical.com

CE
0459